

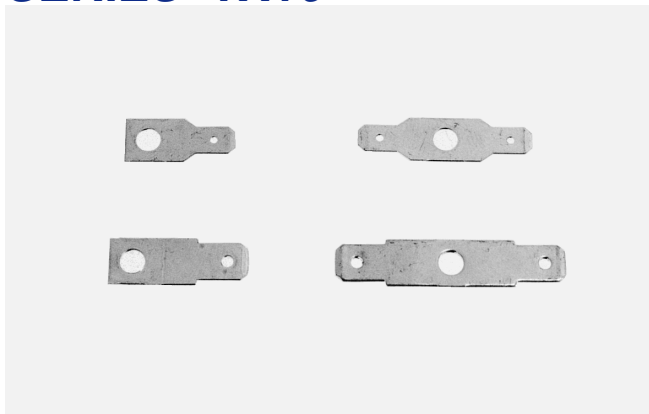

SERIES TX16



Ordering Information

TX16-A1

*Select desired part number from the drawings.

Terminal Block "Quick Terminals"

Specifications

Material:

Terminal: Brass, tin plated

Electrical:

Current rating: 16 Amps max

TERMINAL BLOCKS

TX16-A SERIES

(Available In 3 Configurations)

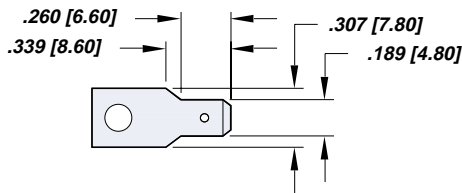

TX16-A1

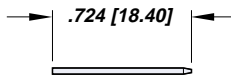

TX16-A2

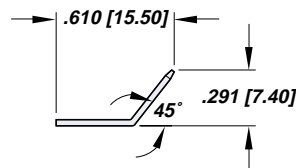

TX16-A3

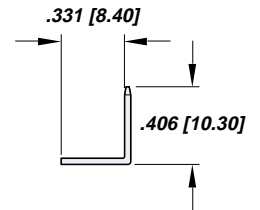

TX16-B SERIES

(Available In 3 Configurations)

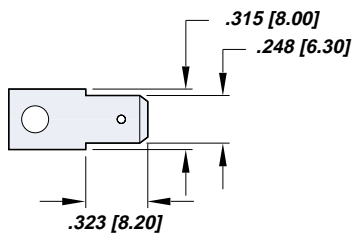

TX16-B1

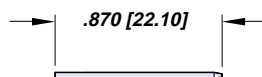

TX16-B2

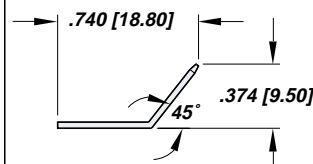

TX16-B3

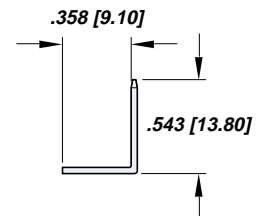

TX16-C SERIES

(Available In 6 Configurations)

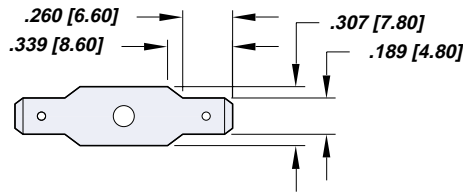

TX16-C1

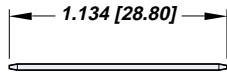

TX16-C2

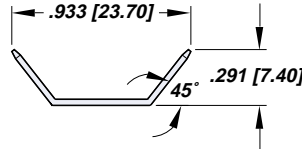

TX16-C3

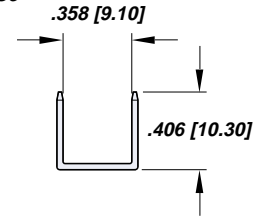

TX16-C4

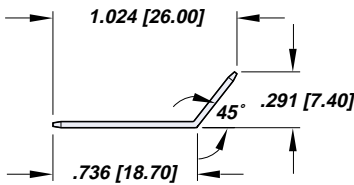

TX16-C5

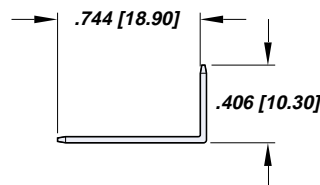

TX16-C6

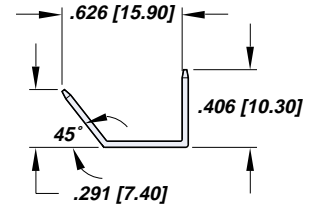

TX16-D SERIES

(Available In 6 Configurations)

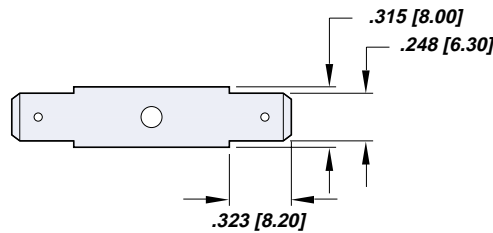

TX16-D1

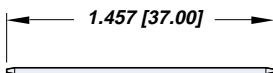

TX16-D2

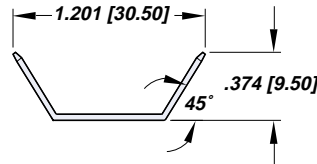

TX16-D3

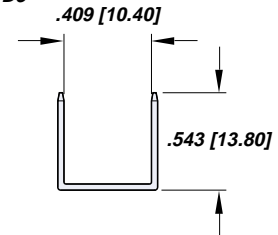

TX16-D4

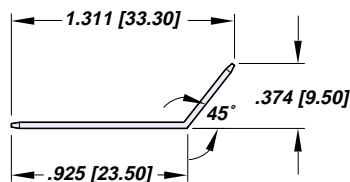

TX16-D5

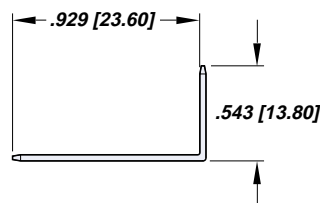

TX16-D6

