

SERIES TX10

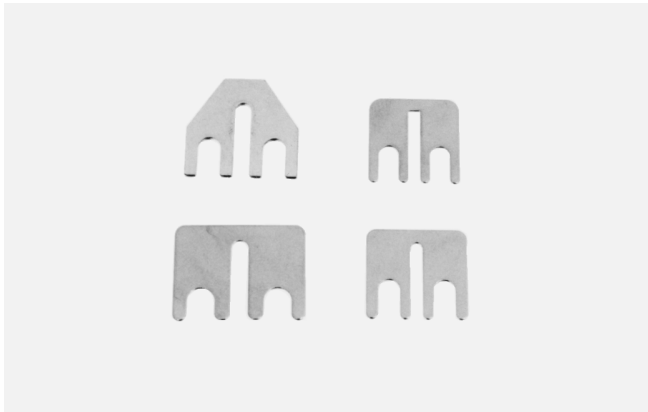

Ordering Information

TX10-B
1

1. Configuration

- A = 7.62 mm pitch
- B = 8.25 mm pitch
- C = 9.50 mm pitch
- D = 11.00 mm pitch

Terminal Block Jumpers

Specifications

Material:

Terminal: Brass, tin plated

Electrical:

Current rating: 16 Amps max

Configuration A

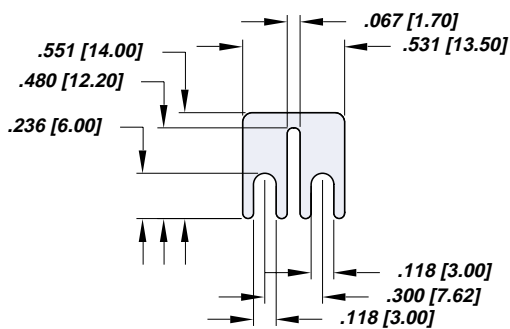

Configuration B

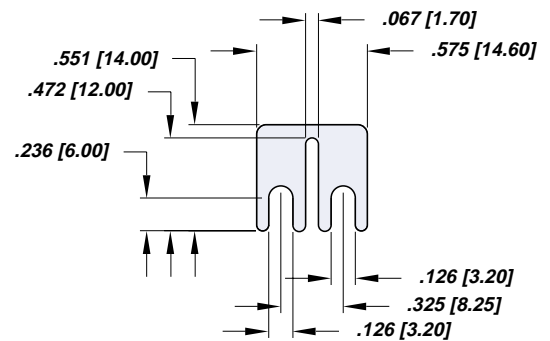

Configuration C

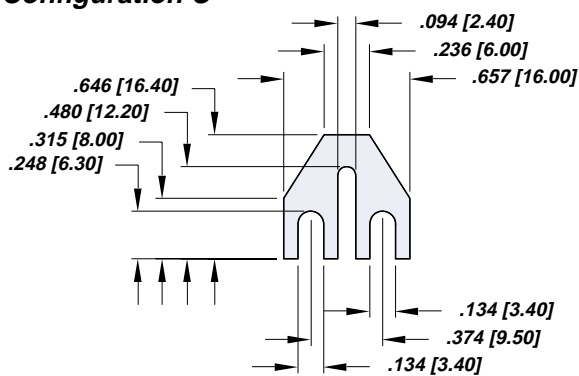

Configuration D

