



SERIES TB21



3 Wall Barrier Terminal Block

Specifications

Material:

Insulator: Polyamide 6.6, black, rated UL 94V-0
 Contacts: Brass, tin plated
 Screws: Steel, nickel plated

Plating:

200 μ" tin-lead over 100 μ" copper underplate, or optional gold flash over 100 μ" nickel underplate

Electrical:

Operation voltage: Pitch A, B, and C = 300V AC max, D = 520V AC max
 Current rating: Pitch A = 10 Amps max, Pitch B and C = 15 Amps max, Pitch D = 20 Amps max
 Insulation resistance: 1000 MΩ min @ 500V DC between adjacent contacts (75°F and 50% R.H.)
 Dielectric withstanding voltage: 2000V AC min rms (sea level)

Mechanical:

Wire Range: 22-16 AWG
 Operating temperature: -40°C to +105°C

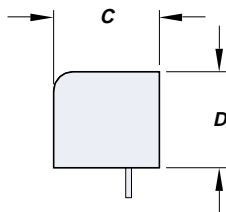

Ordering Information

TB21-1A06NT

1 2 3 4 5

- Configuration**
 1 = Center pin vertical PCB
 2 = Side exit PCB
 3 = Solder eyelet
 4 = Right angle PCB

- Pitch:**
 A = 6.35mm
 B = 8.25mm
 C = 9.50mm
 D = 11.0mm

- Positions:**

Pitch	W/O Ears	With Ears
A	02 - 31	02 - 29
B	02 - 31	02 - 29
C	02 - 31	02 - 29
D	02 - 26	02 - 24

- Mounting options:**
 N = Without mounting ears *
 H = With mounting ears
- Plating Options:**
 F = Gold flash
 T = Tin *

Available Versions

Conf	Pitch			
	A	B	C	D
1	•	•	•	•
2	•	•	•	•
3	•	•	•	•
4	•	•	•	•

* standard

TB21-1

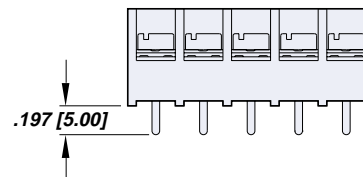
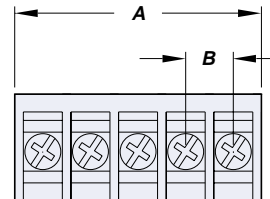

Pitch	Dim A	Dim C	Dim D
B = 6.35 mm	.250 [6.35] X No. of Pos. + .047 [1.20]	.551 [14.00]	.500 [12.70]
B = 8.25 mm	.325 [8.25] X No. of Pos. + .047 [1.20]	.598 [15.20]	.500 [12.70]
B = 9.50 mm	.374 [9.50] X No. of Pos. + .059 [1.50]	.701 [17.80]	.591 [15.00]
B = 11.0 mm	.394 [10.0] X No. of Pos. + .047 [1.20]	.811 [20.60]	.709 [18.00]



TB21-2

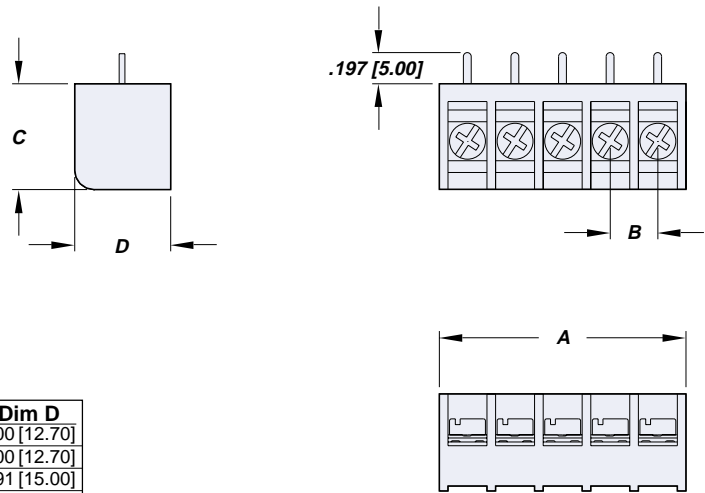

Pitch	Dim A	Dim C	Dim D
B = 6.35 mm	.250 [6.35] X No. of Pos. + .047 [1.20]	.551 [14.00]	.500 [12.70]
B = 8.25 mm	.325 [8.25] X No. of Pos. + .047 [1.20]	.598 [15.20]	.500 [12.70]
B = 9.50 mm	.374 [9.50] X No. of Pos. + .059 [1.50]	.701 [17.80]	.591 [15.00]
B = 11.0 mm	.394 [10.0] X No. of Pos. + .047 [1.20]	.811 [20.60]	.709 [18.00]

TB21-3

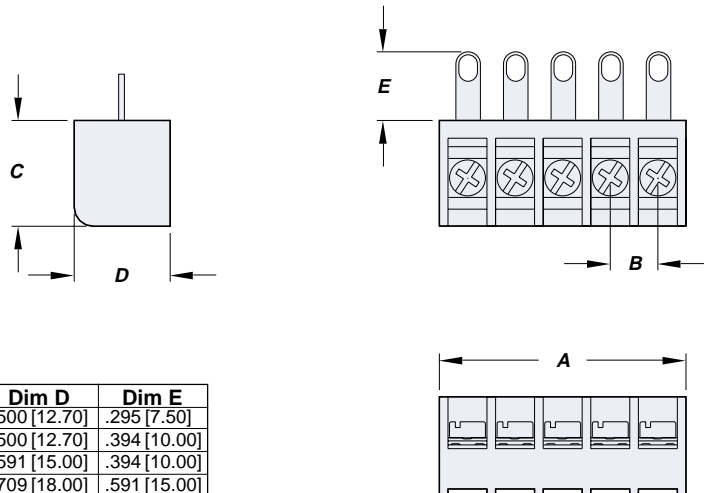

Pitch	Dim A	Dim C	Dim D	Dim E
B = 6.35 mm	.250 [6.35] X No. of Pos. + .079 [2.00]	.551 [14.00]	.500 [12.70]	.295 [7.50]
B = 8.25 mm	.325 [8.25] X No. of Pos. + .079 [2.00]	.591 [15.00]	.500 [12.70]	.394 [10.00]
B = 9.50 mm	.374 [9.50] X No. of Pos. + .039 [1.00]	.709 [18.00]	.591 [15.00]	.394 [10.00]
B = 10.0 mm	.394 [10.0] X No. of Pos. + .039 [1.00]	.811 [20.60]	.709 [18.00]	.591 [15.00]

TB21-4

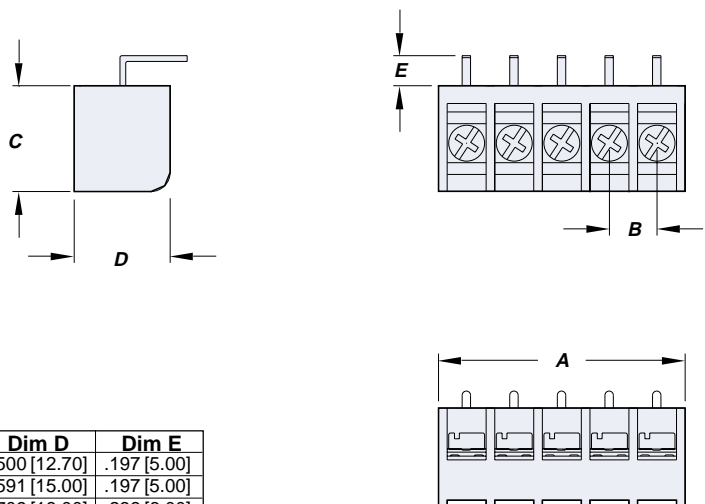

Pitch	Dim A	Dim C	Dim D	Dim E
B = 8.25 mm	.325 [8.25] X No. of Pos. + .079 [2.00]	.591 [15.00]	.500 [12.70]	.197 [5.00]
B = 9.50 mm	.374 [9.50] X No. of Pos. + .039 [1.00]	.709 [18.00]	.591 [15.00]	.197 [5.00]
B = 10.0 mm	.394 [10.0] X No. of Pos. + .039 [1.00]	.811 [20.60]	.709 [18.00]	.236 [6.00]