

SERIES DX78

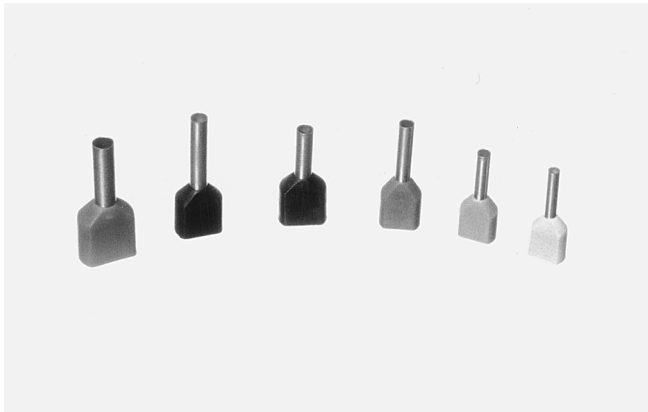

Ordering Information

DX78-108

- Part Number:**
Select desired part number from the chart.

Dual Crimp Ferrule

Specifications

Material:

Insulator: Thermoplastic to DIN 46 228 part 4

Contact: Copper, tin plated

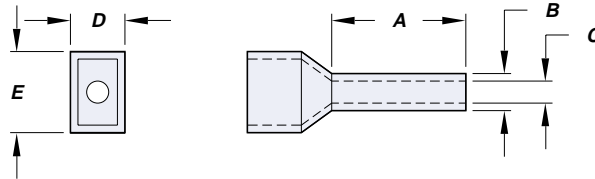

Part Number	For Wire Size		Dimensions										Color
	AWG	mm ²	A		B		C		D		E		
108	20	0.50	.315	8.00	.071	1.80	.043	1.50	.142	3.60	.220	5.60	White
208	18	0.75	.315	8.00	.083	2.10	.043	1.80	.138	3.50	.244	6.20	Gray
210	18	0.75	.394	10.00	.083	2.10	.043	1.80	.138	3.50	.244	6.20	Gray
308	17	1.00	.315	8.00	.091	2.30	.051	2.00	.157	4.00	.236	6.00	Red
310	17	1.00	.394	10.00	.091	2.30	.051	2.00	.157	4.00	.236	6.00	Red
408	16	1.50	.315	8.00	.102	2.60	.051	2.30	.165	4.20	.283	7.20	Black
413	16	1.50	.512	13.00	.102	2.60	.059	2.30	.165	4.20	.283	7.20	Black
510	14	2.50	.394	10.00	.130	3.30	.059	2.90	.197	5.00	.335	8.50	Blue
513	14	2.50	.512	13.00	.130	3.30	.059	2.90	.197	5.00	.335	8.50	Blue
612	12	4.00	.472	12.00	.165	4.20	.067	3.80	.224	5.70	.362	9.20	Gray
714	10	6.00	.551	14.00	.209	5.30	.067	4.90	.268	6.80	.413	10.50	Yellow
814	7	10.00	.551	14.00	.272	6.90	.067	6.50	.315	8.00	.512	13.00	Red
914	6	16.00	.551	14.00	.358	9.10	.079	8.70	.413	10.50	.760	19.30	Blue